

Tavola 1:
Piazza Canonico Nicolazzi,
pianta del piano seminterrato.



Tavola 2:
Piazza Canonico Nicolazzi,
pianta del piano terreno (1° f.t.).



Tavola 3:
Piazza Canonico Nicolazzi,
pianta del piano primo - sottotetto (2° f.t.).

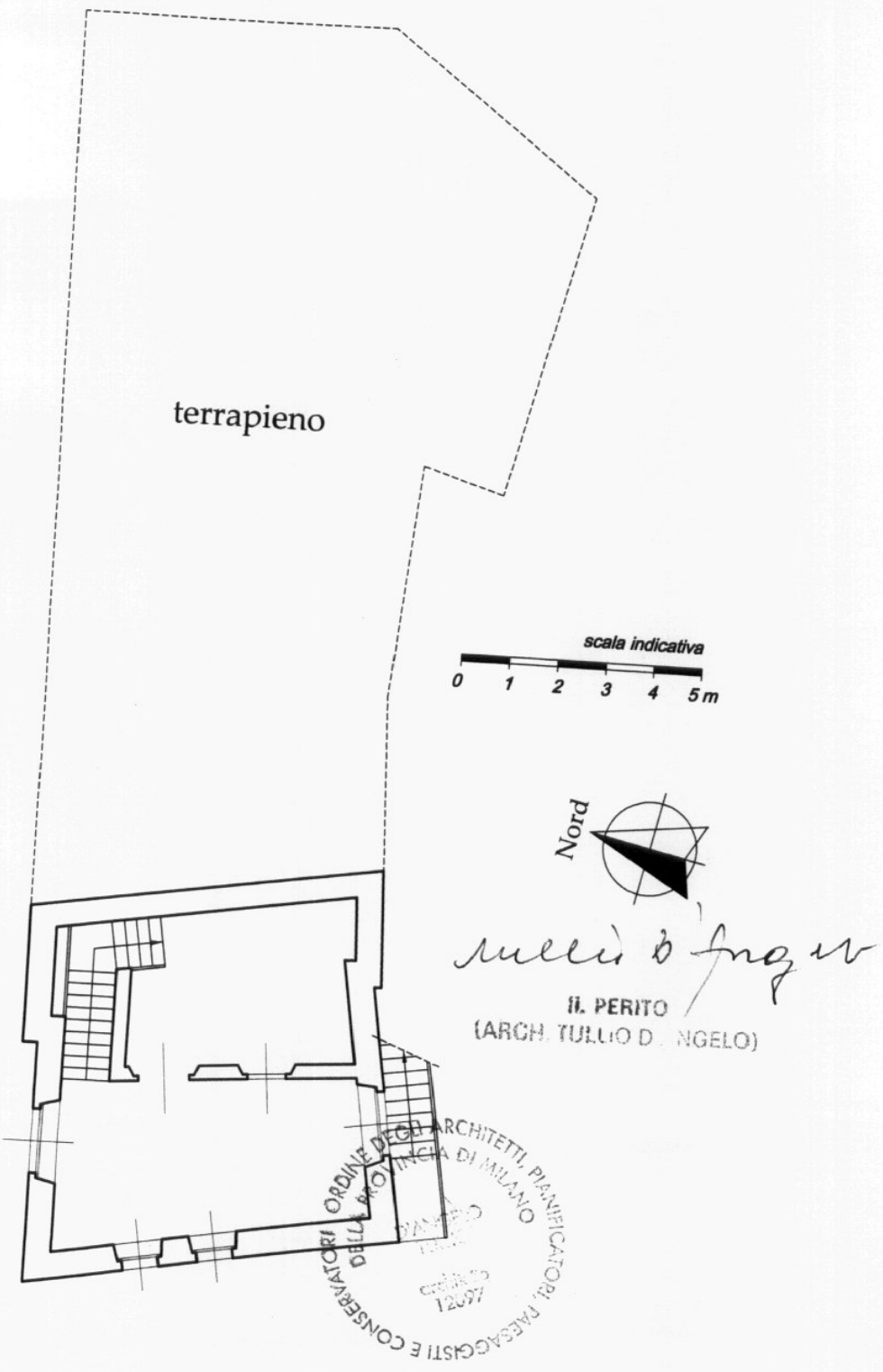

Tavola 4:
Piazza Canonico Nicolazzi,
pianta del piano secondo (3° f.t.) e della copertura.

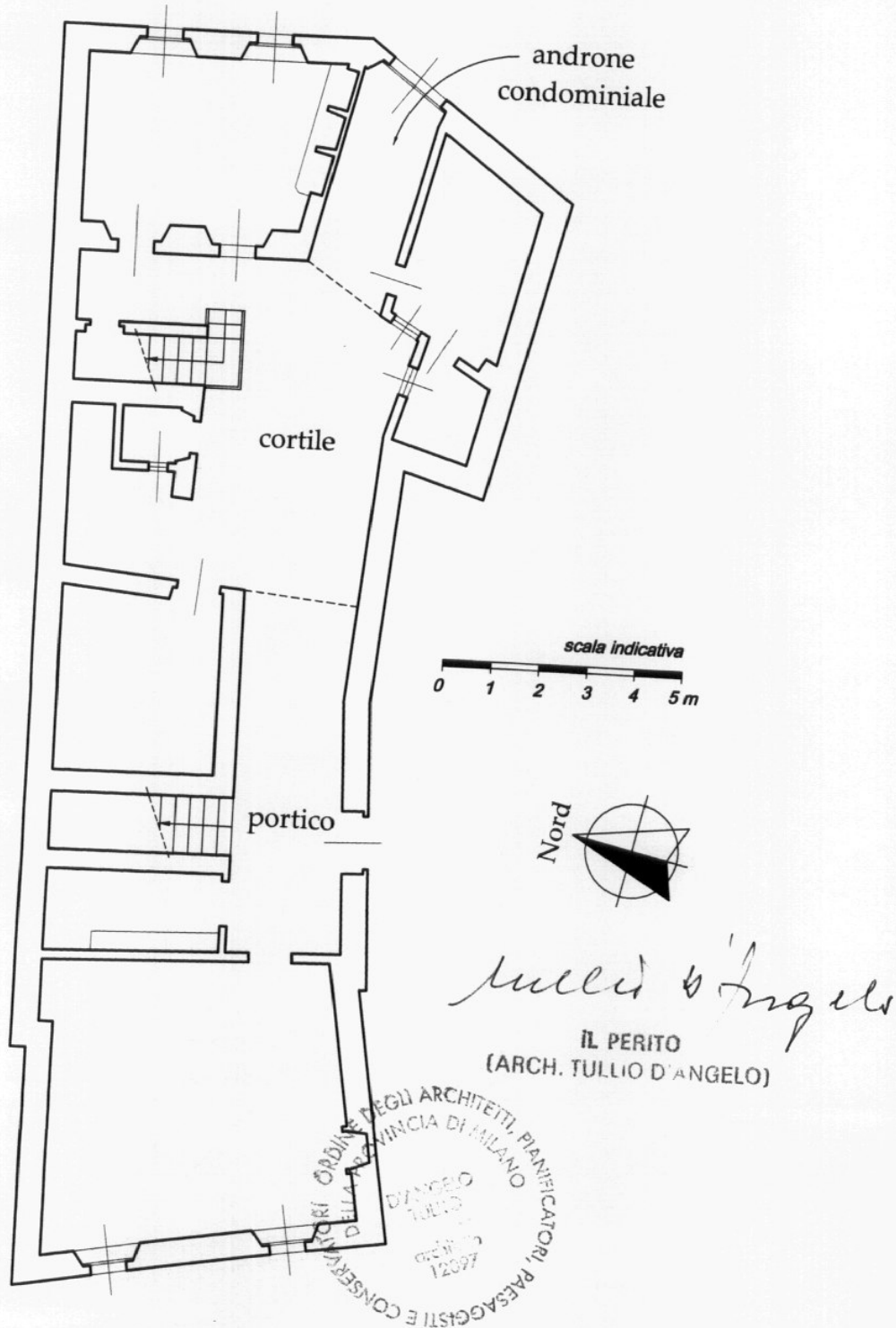

Tavola 5:
 Strada Statale n. 33 del Sempione,
 planimetria generale della proprietà.

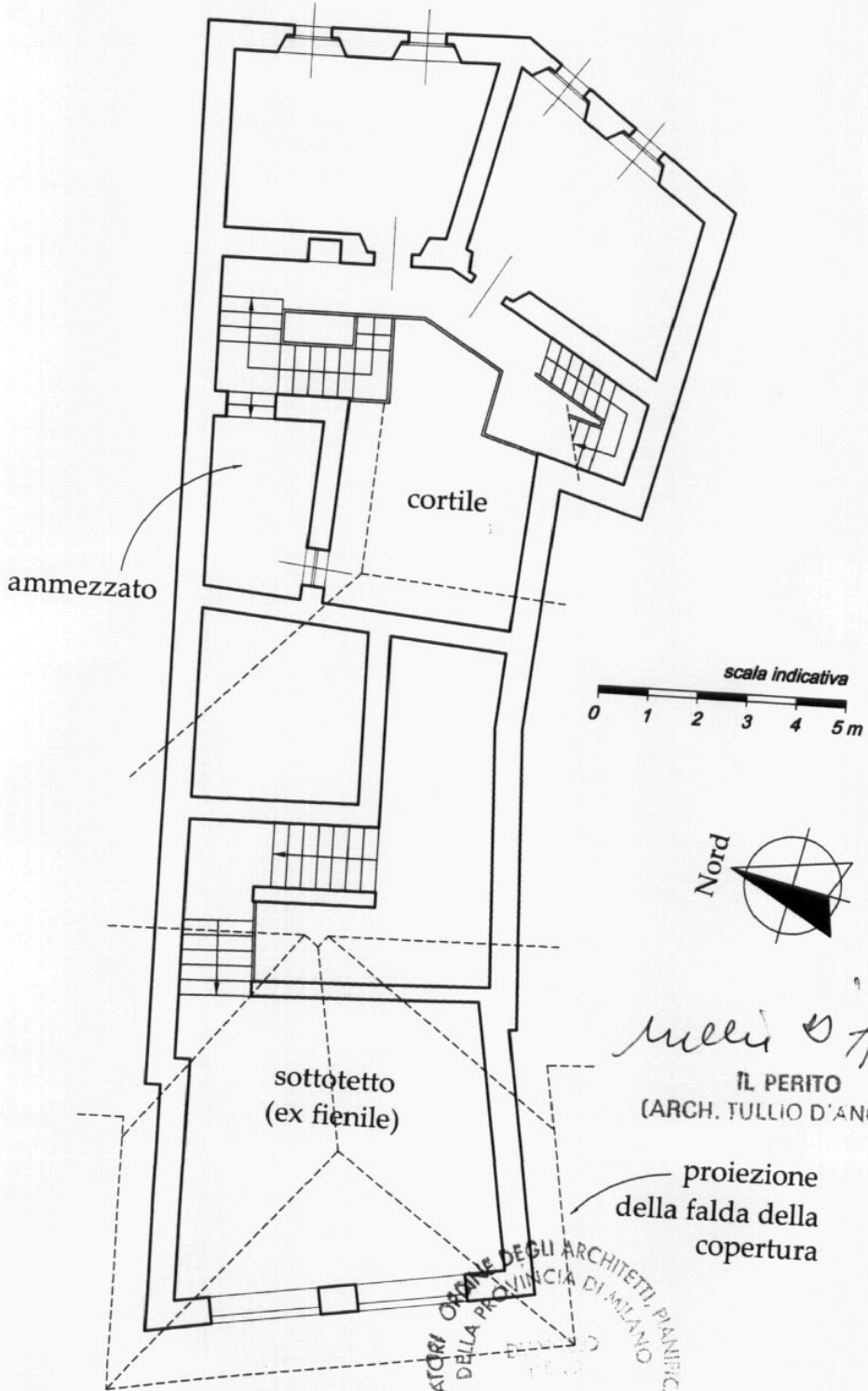

ORDINE DEGLI ARCHITETTI, PIANIFICATORI
 DELLA PROVINCIA DI MILANO
 CONSERVATORI
 DELLA
 ARCHITETTURA
 12/07

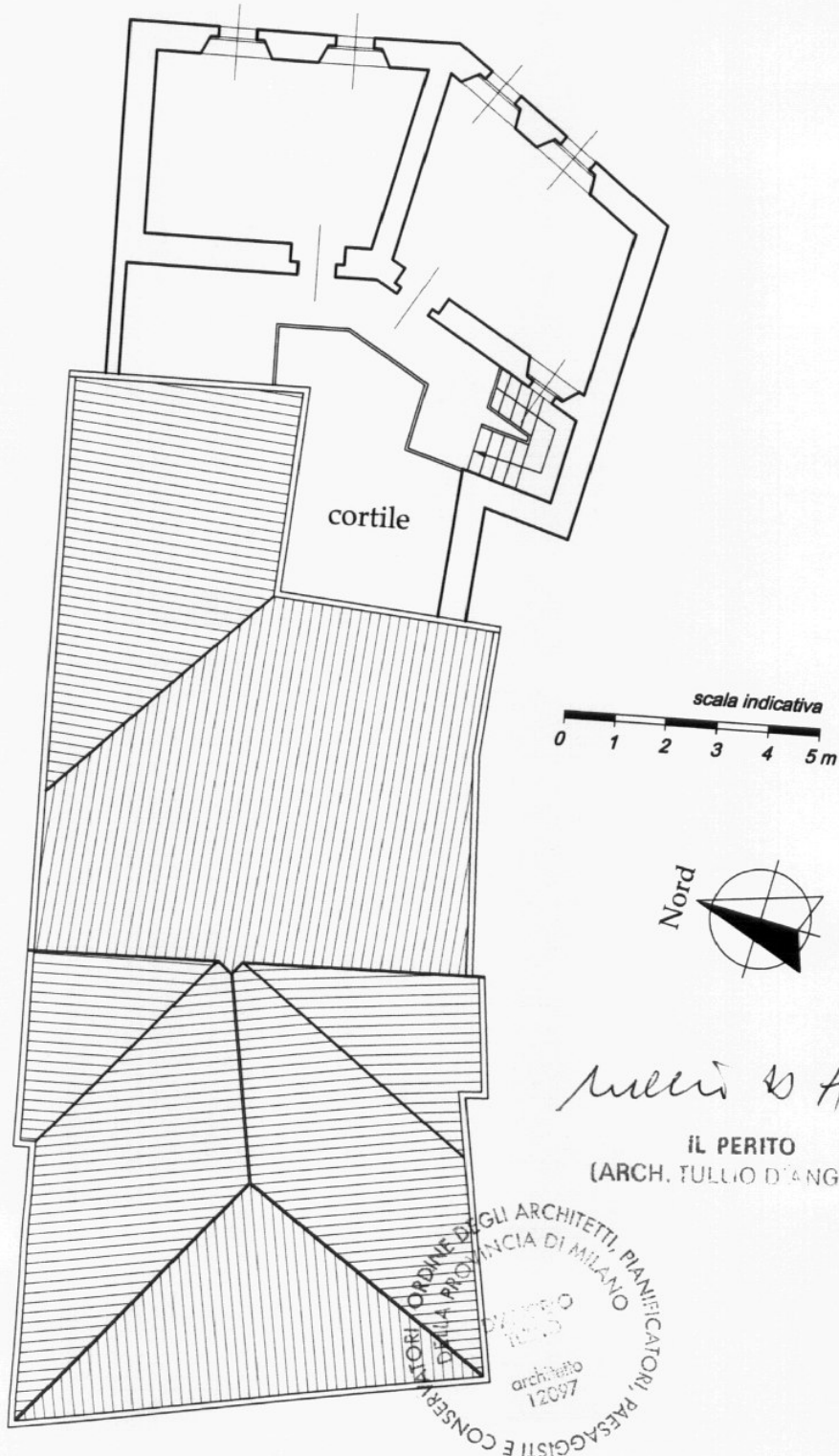
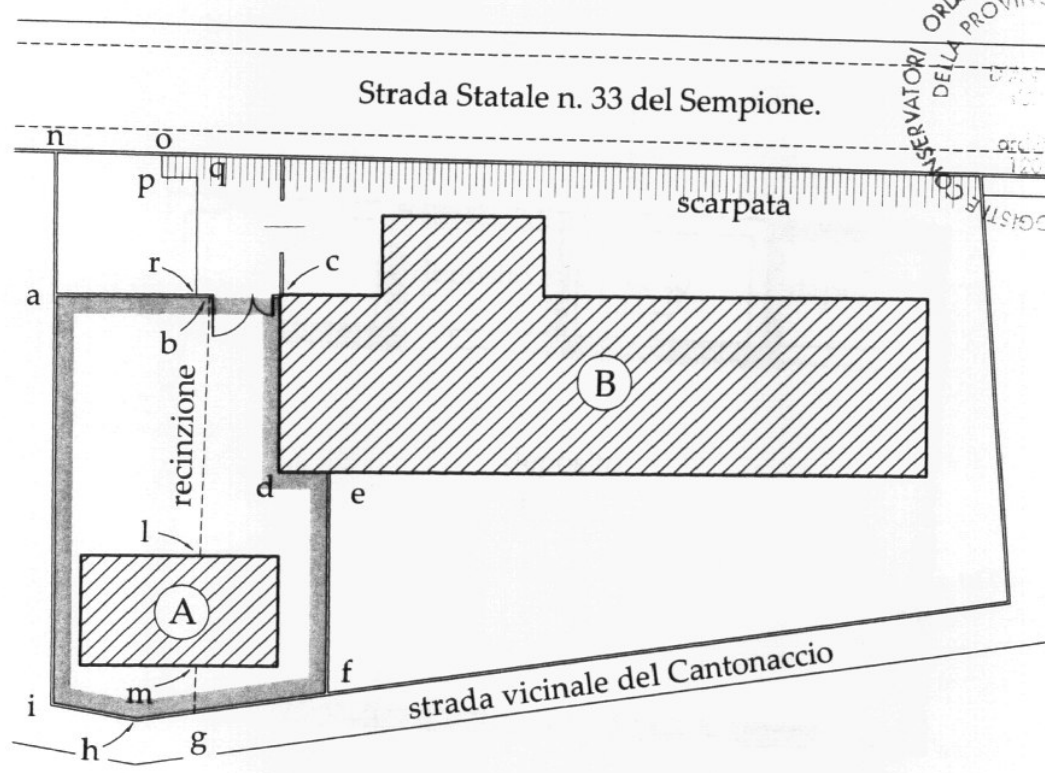
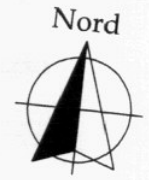
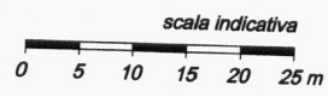

Tullio d'Angelo

IL PERITO
 (ARCH. TULLIO D'ANGELO)

Tavola 6:
Strada Statale n. 33 del Sempione,
pianta del piano terreno (1° f.t.).

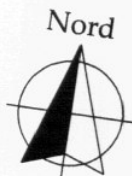
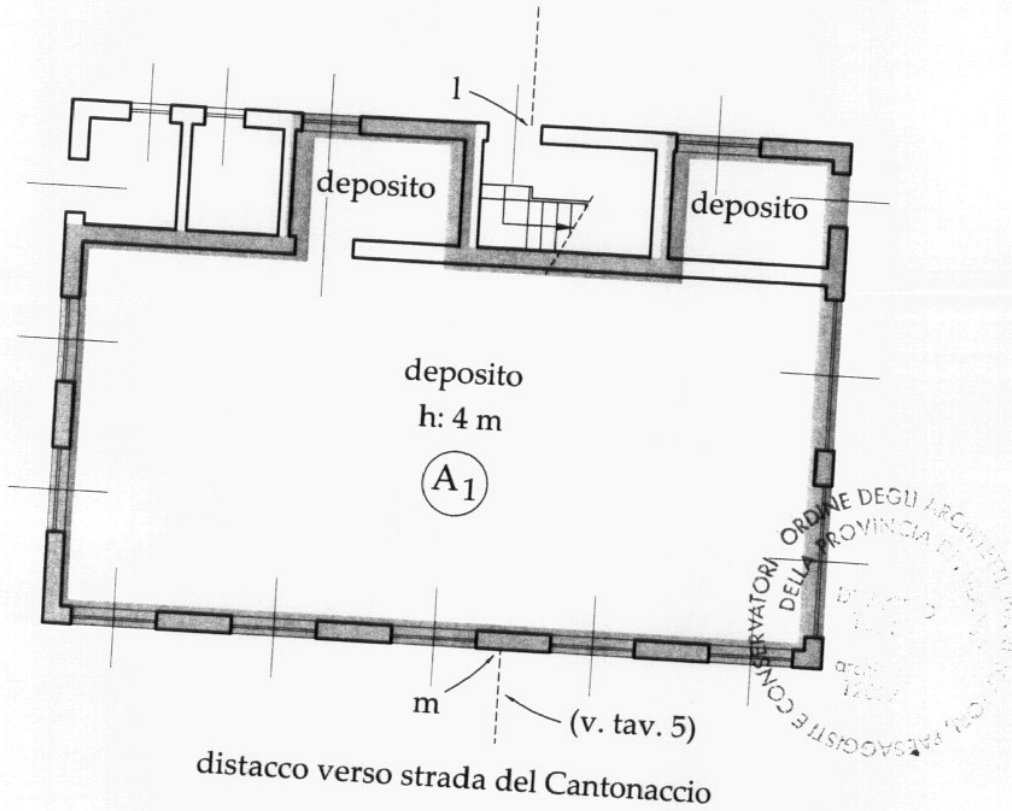

Tullio D'Angelo
IL PERITO
(ARCH. TULLIO D'ANGELO)

Tavola 7:
Strada Statale n. 33 del Sempione,
pianta del piano primo (2° f.t.).

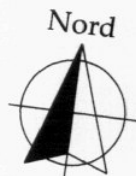
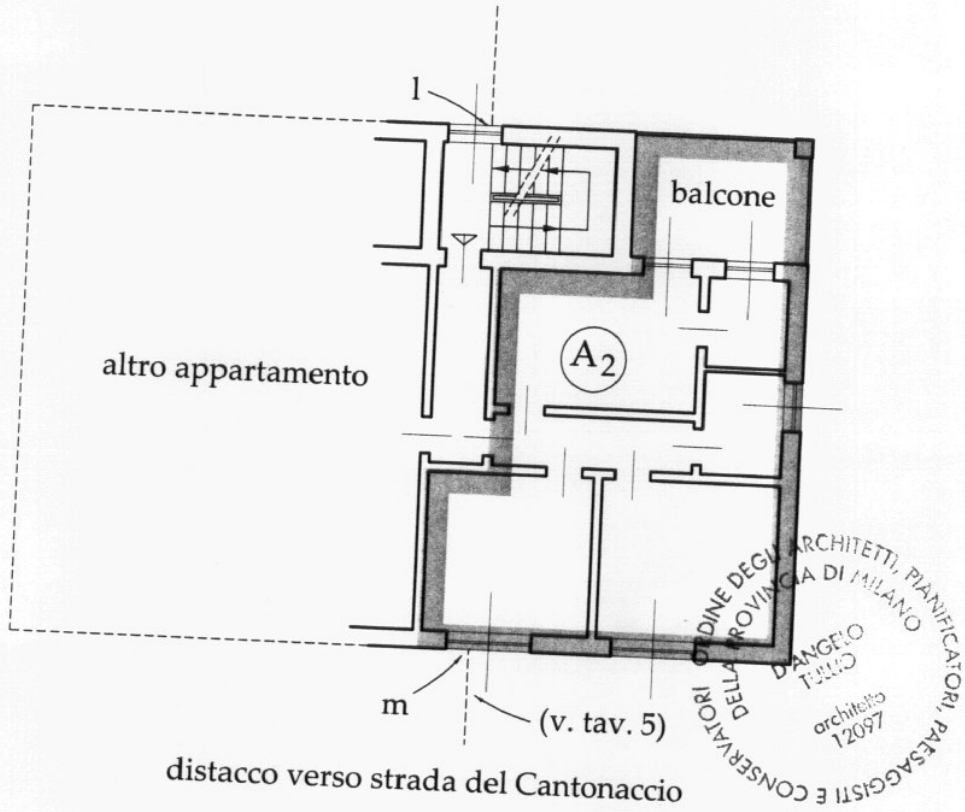

Tullio D'Angelo
IL PERITO
(ARCH. TULLIO D'ANGELO)